

## 1. Prepare the opening

Frame opening to suite desired door size.

## 2. Fit CF in opening

Nail or screw frame to stud and floor ensuring frame is plumb, square and not twisted. Pack above head as required and nail or screw as required.

## 3. Fit jambs and headboard

Fit closing jamb (accessory) and headboard. Underside of headboard sits on top of CF split jamb timber.

## 4. Fit track

Clean the track.

Remove the carrier door plates from the carriers and insert the carriers onto the track.

If using Flush Pulls, the doors can be stopped short from fully opening by using the track stop supplied. Insert the track stop into the track and clamp in desired location with spanner. Track stop can be retro-fitted later by unscrewing track and inserting stop. If sliding flush to jamb, the track stop is not required. Secure the track tightly to the frame by inserting head mounting rivets into the keyhole slots in the track and push track firmly towards the back of the frame until it locks. Level the track horizontally and screw to the headboard using all screw holes.

## 5. Fit carrier plates to door

Fit the carrier plates to the top of the door. The open slots in the carrier plates must both face to the same side of the door.

## 6. Fit rubber buffer

Screw rubber buffers to back of door style.

## 7. Hang door

Angle the door between the split jambs and lift up so the carrier door plates engage onto the carrier bolts. Close the door and adjust the carrier bolts so that the door lines up with closing jamb. Tighten lock nuts.

## 8. Fit cover strips and pelmets

Fit cover strips (not supplied) to closing jamb. Fit removable pelmets (accessory) using 4 x 75mm screws supplied.

## 9. Fit floor guides

Screw nylon guides to CF split jambs and adjust for free movement of door.

## 10. Test door panel

Adjust and test for full travel and free movement prior to installation of wallboard or lining to outside of cavity unit. *Failure to test prior to installation of wallboard could result in expensive rectification.*

## 11. Finish cladding

Fix plaster board to CF (10 mm standard or 13mm for 64 stud) steel noggings by placing the desired number of walnuts of adhesive over the punched holes in the noggings. Press against the board to force a small amount of glue through the holes to form locking buttons on the inside of the frame. Fit the architraves and skirting.

## SPECIFICATIONS

Shipping Weight	11 kg (approx)
Door Height	2040mm / 230mm (standard)
Rated Capacity	60kg (maximum)
Track	box section
Track Profile	Centor A9 Series
Track Material	Anodised aluminium
Carriers	4 wheel, steel bracket
Wheels	Nylon tyred, steel bearings
Frame	coated steel
Split Jamb	Meranti standard
Contents	cavity frame
	track
	2 x door carriers
	2 x door wedge guides
	2 x door buffers
	1 x track stop
	4 x carrier screws
	9 x fixing screws
	2 x stop screws
	2 x guide screws
Specials	4 x pelmet screws
	fitting instructions
	available on request
Accessories	up to 1200mm wide doors
	up to 2340mm high doors
Accessories	CF timber kit (closing jamb & pelmets)

### INSTRUCTION 6 – FIT RUBBER BUFFER

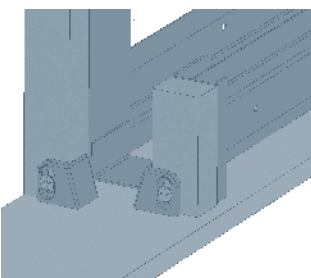

### INSTRUCTION 7 – HANG DOOR

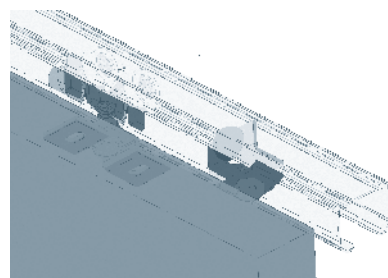

### INSTRUCTION 10 – FINISH CLADDING

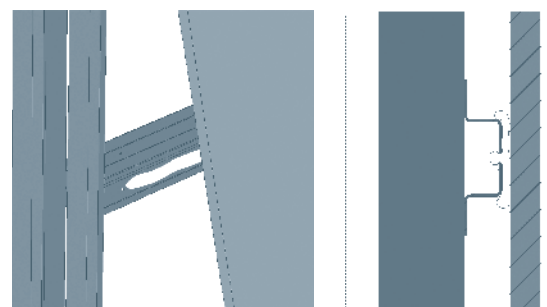

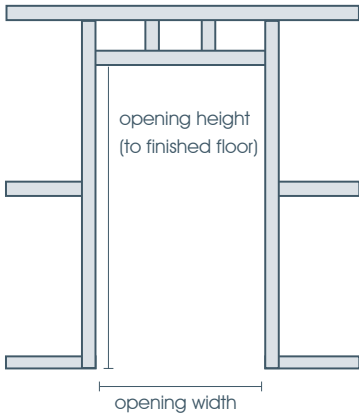

**Opening Sizes for Standard Frames**

Opening height = 2135mm from finished floor to head  
 Opening width (single) = door width x 2 + 15mm (stud to stud)  
 Opening width (double) = door width x 4 – 10mm (stud to stud)

**Double Doors**

Additionally order 2 x 9TS Track Stops

**Jamb Alignment**

Door will finish flush with jambs when fully open. If projection is required to allow for 'flush pulls' use supplied 9TS Track Stop. Clamp Track Stop in track at required projection.

**64mm Frames**

64mm frames are made to suit 13mm Gyprock, instead of standard 10mm. Architraves will need to be rebated 3 x 35mm to provide flush fit with 10mm wall lining.  
*Note: special pricing applies.*

Stud	Door Width	Door Thickness
64mm	620mm	35mm
	720mm	35mm
	770mm	35mm
	820mm	35mm
	870mm	35mm
70mm	620mm	35mm
	720mm	35mm
	770mm	35mm
	820mm	35mm
	870mm	35mm
75mm	620mm	35mm
	720mm	35mm
	770mm	35mm
	820mm	35mm
	870mm	35mm
90mm	620mm	35 / 40mm
	720mm	35 / 40mm
	770mm	35 / 40mm
	820mm	35 / 40mm
	870mm	35 / 40mm
100mm	620mm	35 / 40mm
	720mm	35 / 40mm
	770mm	35 / 40mm
	820mm	35 / 40mm
	870mm	35 / 40mm

ARCHITECTURAL DETAIL – SIDE VIEW

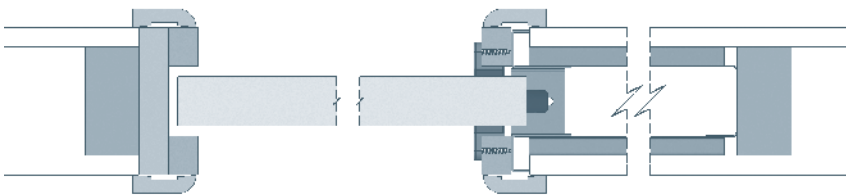

ARCHITECTURAL DETAIL – END VIEW

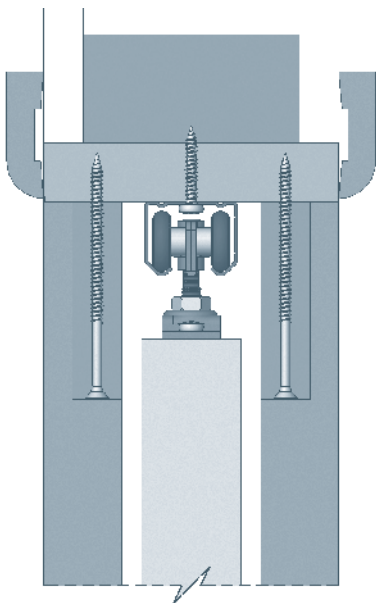

ARCHITECTURAL VIEW – TOP VIEW

